

Installation and Operation Instructions

GoLift Portable**450**



Contents

Introduction	3-4
Symbols used in this Manual	4
Markings	4
Safety Instructions	5
Technical Specifications for Amico GoLift Portable	6
Anatomy of the GoLift Portable	7
Basics in Transferring a Patient	8-9
Installing the Portable trolley in the Amico PLP Track	9-10
Installing the Endstop on the Amico Track	10
Using the Reacher Bar	11
Connecting the Capacitive Touch Hand Control to the GoLift Portable	11
Operating the GoLift Portable	12
Charging the GoLift Portable	12
LED and Buzzer Functions	13
Emergency Stop	13
Emergency Lowering	14
Manual Emergency Lowering	14
Overspeed Cam	14
Cleaning and Disinfection	15
Troubleshooting	15
Inspection and Maintenance	16
GoLift Portable Accessories	17
GoTrack Systems and Support Structure	18
Environmental Conditions	19
Electro-Magnetic Compliance Data for Amico GoLift Portable	20-23
Warranty	24

Introduction

APPLICATION

The primary purpose of the GoLift Portable system is to safely lift and transfer a patient within an institutional setting or at home. The GoLift Portable allows these transfers with as little effort as possible for the caregiver, while providing dignity to the patient. A ceiling lift is simple and safe for the caregiver as well as the patient. The lift can be easily moved by a caregiver by along the track from one location to another.

DESCRIPTION

The Amico GoLift Portable is an ideal ceiling lift system designed for routine transfers of patients. The most compact portable lift in its class, the Amico GoLift Portable is designed to be aesthetically pleasing to both the caregiver and the patients. In an effort to address infection control requirements, we gave careful consideration to the smooth edges and rounded corners of our ceiling lift, carry Bar and hand control. When you look under the cover of this compact lift, you will find an impressive set of all metal gears and state-of-the-art battery technology that will allow the caregiver to safely, and effortlessly, transfer a patient weighing up to 450 lbs on a single lift.

The GoLift Portable weight capacity is 450 lbs. This weight limit must not be exceeded.

The Amico GoLift Portable is a fixed lift and can be installed in a variety of track profiles (the trolley can be customized to fit these track profiles) and it also works seamlessly with the Amico GoLift Portable Pendant (PLP) System.

Contents of Packaging:





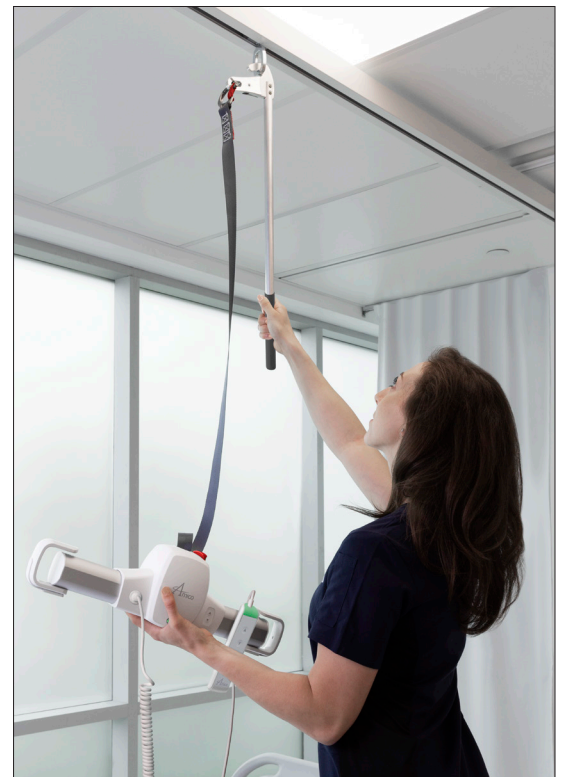

1. Amico GoLift Portable450
2. Capacitive Touch Hand Control
3. Charger
4. Owner's Manual
5. Portable Trolley

Upon receipt of the packages, verify it against the packing slip to ensure the shipment is complete and inspect the equipment for possible damage. If there is any damage, DO NOT USE the equipment and notify the carrier immediately to file a claim. Provide complete information concerning damage claims or shipping errors to Amico Mobility Solutions Corporation. Include all equipment identification numbers along with a description of the damaged parts.



Introduction

SYMBOLS USED IN THIS MANUAL

Symbol	Reference	Title
	ISO 7000-0434A	Caution risk of danger
	TUV	Certified by TUV
	IEC 60417-5840	Type BF Applied Part
	CE	Certification of Conformity
	ISO 7010-M002	Refer to instruction manual/booklet
	Amico Mobility	Emergency Lowering
	N/A	N/A



WARNING: This symbol is intended to alert the user of hazard or unsafe practices, which could result in serious bodily harm.

MARKINGS

The GoLift Portable 450 are designed to comply with the following Standards:

Standard(s):	CAN/CSA-C22.2 No. 60601-1:08 Medical Electrical Equipment – Part 1: General requirements for basic safety and essential performance. ISO10535:2006 Hoists for the transfer of disables persons – Requirements and Test Methods. CAN/CSA-C22.2 60601-1-11:2-15 home use environments.
Product:	Amico GoLift Portable
Brand Name:	GoLift
Models:	450 lbs



AJW Technology Consulting GmbH
Königsallee 106
40215 Dusseldorf
Germany

Safety Instructions



READ THESE INSTRUCTIONS CAREFULLY OR SERIOUS INJURY MAY OCCUR

- The Amico GoLift Portable must be installed only by personnel authorized by Amico Mobility Solutions Corporation.
- Do not use this equipment prior to understanding the contents of this manual.
- Contents of this manual are subject to change without prior notice to users. Keep for future reference.
- Never place the Amico GoLift Portable, track/PLP and sling(s) in control of a person who has not been properly trained in the use and care of this equipment.
- The Amico GoLift Portable and associated Track/PLP and sling(s) are for transferring patients only. Never use the GoLift Portable for any other purpose.
- Amico Mobility's Warranty is void if unauthorized personnel perform service on the Amico GoLift Portable system.
- In facilities where more than one caregiver is responsible for using the Amico GoLift Portable and associated track and slings, it is important that all caregivers be trained in the proper use of this equipment. A training program should be established by the facility to familiarize new caregivers with this equipment.
- Do not expose the Amico GoLift Portable directly to water. Warranty does not cover any misuse or abuse of the Amico GoLift Portable.
- The Amico GoLift Portable should be inspected and maintained on a regular basis to keep it operating safely and correctly. Refer to page 16 of this manual.
- Any accessories used with the Amico GoLift Portable including the track/PLP and sling(s) should be checked to ensure that they are in good working order. Check for signs of wear or fraying prior to use. Report any unusual wear or damage immediately.
- Amico Mobility will not be responsible for any damage caused by misuse, neglect or purposeful destruction of the lift and its associated components. Do not attempt to modify/alter the Amico GoLift Portable.
- Do not in any circumstance exceed the maximum allowable load of this lift. Refer to the "Technical Specifications" section of this manual and/or the labels on the lift.
- The installation of the lift, track and sling are certified to a maximum load. Do not exceed the maximum rated load of any of the components.
- There is a risk of explosion if the lift is used in the presence of flammable anesthetics.
- The Amico GoLift Portable should be decommissioned/disposed of after the recommended service life in accordance with local law regulations.
- If the battery case cracks and the contents of the battery contact your skin or clothing rinse immediately with warm water.
- If the contents of the battery contact your eyes, rinse immediately with plenty of water and seek medical attention.
- If the contents of the battery can cause respiratory irritation. Provide fresh air and seek medical attention.



There are no known contraindications associated with the use of the Amico GoLift Portable and its accessories, provided they are used per our recommendations and guidelines.

However, for any independent users of the Amico GoLift Portable, it is extremely important that the patient is able to receive assistance, during the transfer in the event of an equipment failure. This assistance can be provided in the form of; a nearby qualified caregiver, a phone or other communication device.

Technical Specifications for Amico GoLift Portable

Maximum Lifting Speed:

No load: 1 inch/second
150 lbs/68 kg: 0.6 inches/seconds
450 lbs/204 kg: 0.5 inch/seconds

Unit Weight:

6 lbs

Safe Working Load (SWL):

450 lbs

Dimensions (see diagram):

Length: 19.4" (049.27 cm)
Height: 5.2" (13.20 cm)
Depth of Lift: 3.5" (8.89 cm)
Strap Length: 74" (187.96 cm)

Number of Lifts per Charge (Duty: 10/90):

89 with 150 lbs (25% of strap at midrange)
52 with 450 lbs (25% of strap at midrange)
Charging time: 2 - 4 Hours

Lift Case:

Flame retardant ABS
IP27 hand control - 1m water resistance
IP23 Lift - protected from fingers and water
spray less 60 degrees from vertical

Batteries:

High Capacity, Long Lasting NiMH
1 x 24V (1.6Ah)

Battery Charger:

100-240 VAC 40 Watt

Hand Control:

Wired capacitive touch, IPX4

Safety:

Emergency Stop: Yes
Emergency Lowering Device: Independent Electrical
Emergency Manual Lowering
Upper Limit Detection
Lower Limit Detection
Slack Tape Sensor
Free Fall Brake (Over Speed Governor)
Low Battery and Dead Battery indication
Soft Start and Stop
Overload Protection

Approvals:

CAN/CSA-C22.2 No 60601-1:08
CAN/CSA-Z10535.1:15

Expected Service Life:

22,500 cycles or 10 years. It is recommended that the lift be replaced after this time.
The expected life of slings, batteries fuses, straps and cord is dependent upon proper maintenance.

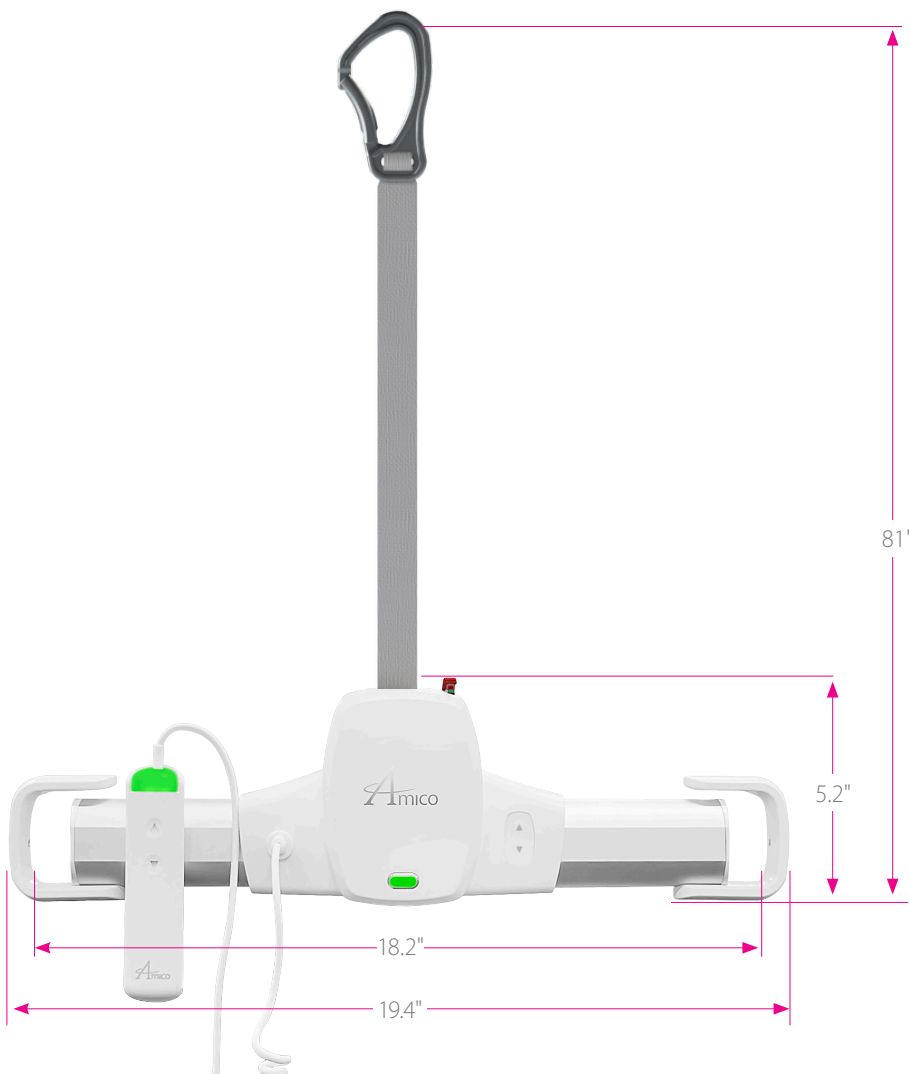

Anatomy of the GoLift Portable450

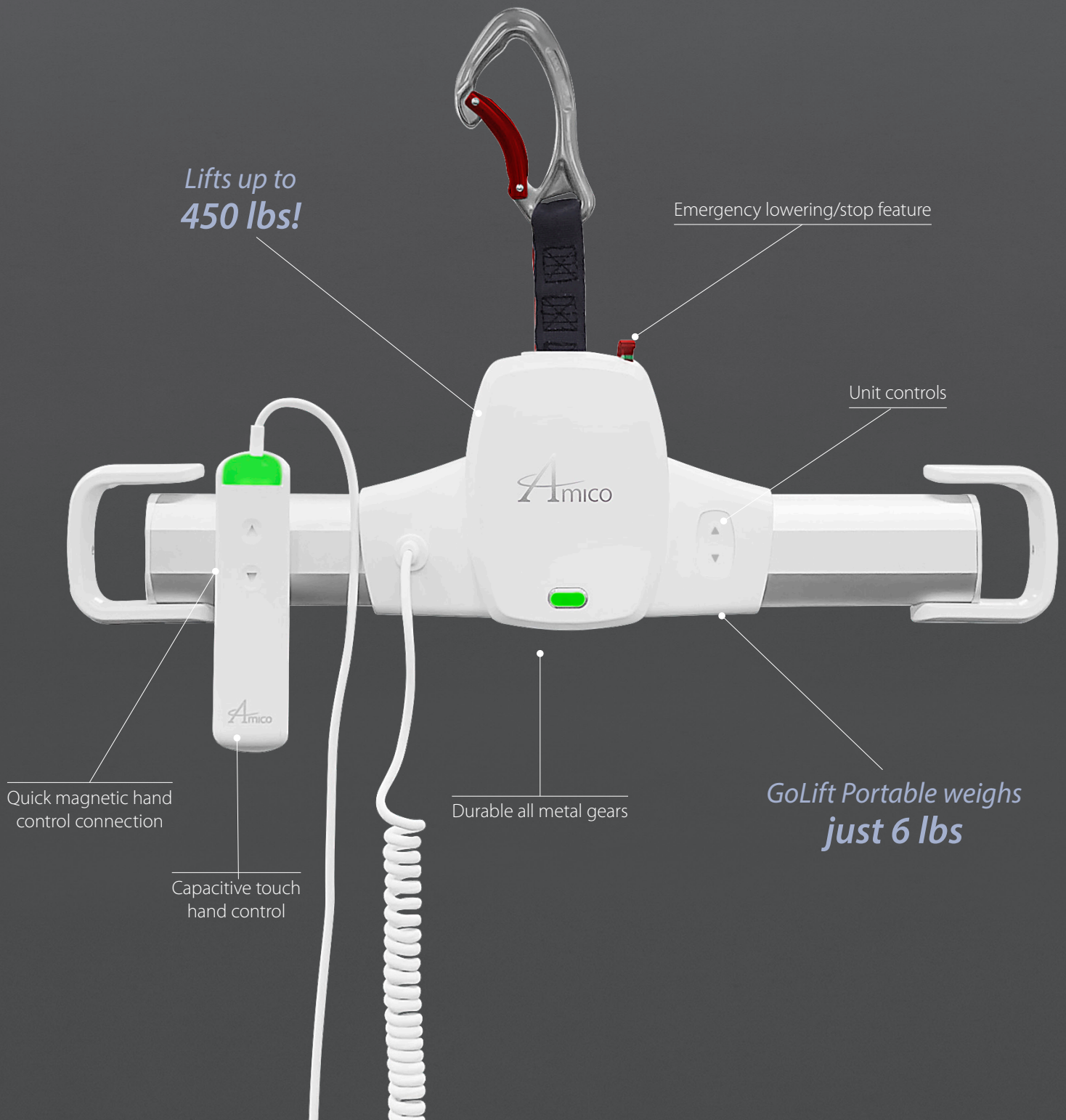

Basics in Transferring a Patient

Lifting Sling:

A lifting sling with four to six straps designed for mounting on hooks should be used with the Amico Portable 450 lift. Place the straps on the hooks and make sure the loops are not in the latch so the straps do not unintentionally fall off.

Amico Mobility shall not be liable for faults or accidents due to incorrect use of the lifting sling, or for reasons of inadequate attention on the part of the caregiver or patient.

Working with the Amico GoLift Portable:

The Amico GoLift Portable moves freely in the track system and does not have any special requirements for space or power in connection with moving. Attention can be fully focused on the user's functional level and the caregivers technique.

To use the GoLift Portable correctly, the patient should only be lifted to the extent that she/he is clear of the surface and should be moved at this height.

Attaching the Lifting Sling:

Place the straps from the lifting sling on the hooks of the GoLift Portable. Start with the uppermost set of straps (from the back) and then take the lowest set of straps (from the legs).



Be careful when attaching the lifting sling on the hooks. Check that the straps have been completely through the opening and into place in the Carry Bar hooks. When pressing the up button to lift the patient, check again that all straps remain correctly placed.

Lifting to and from a seated position:

- When lifting a patient from e.g. a wheelchair, move the Amico GoLift Portable towards the patient to be lifted.
- The lifting hooks should be at the same height as the patient's chest and should not be moved further in over the user to approximately mid-thigh position.
- Place the lifting hooks parallel to the patient's shoulders.
- Place the lifting sling behind the user's back between the back of the chair and the user's back.
- The center band of the lifting sling should follow the user's spine. Lead the leg straps along the outer sides of the patient's shins and beneath the thighs between the hollow of the knees and the hip joints. Cross the leg straps in front of the user.
- All four lifting straps are now ready to be attached. The lifting sling can now be mounted on lifting the hooks.



Basics in Transferring a Patient

Lifting to and from lying position in bed:

- Bring the GoLift Portable over the center of the patient to be lifted.
- Place the hooks parallel to the patient's shoulders.
- Turn the patient onto his or her side. The sling should be placed so that the top of the sling is at the same height as the top of the user's head. Now position the sling over the user so that the center band follows the user's spine. Turn the user onto his or her back and pull out the remaining part of the lifting sling. Place the leg straps beneath the user's thighs and cross them. All four lifting straps are now ready to be attached and the lifting sling can now be mounted on the hooks. It is an advantage to elevate the head of the bed so that the patient is sitting up.
- Only persons who have received competent instruction regarding the use of the lifting equipment and fitting of slings should use the Amico GoLift Portable.



Important: Plan the move and avoid leaving the patient in the sling unattended. Before lifting, check that the patient is completely free of his/her surroundings. The patient's head, arms, hands and feet must not be in danger or becoming trapped. Be careful with any tubes and wires that are attached to the user. Check that the Portable450 hand control and hand control cable is not tangled to the patient and other object before the lift is activated up or down moved.

Never leave the lift unattended in an area such as a Psychiatric Ward with the patient.

Installing the Portable Trolley in the Amico PLP Track

1. Remove both the endcaps on the PLP Arm.



2. Make sure the portable trolley is inserted correctly in the PLP track.



Installing the GoLift Portable in the Amico PLP Track

3. By using an adjustable wrench, remove the endstop on the PLP track by loosening the bolts.

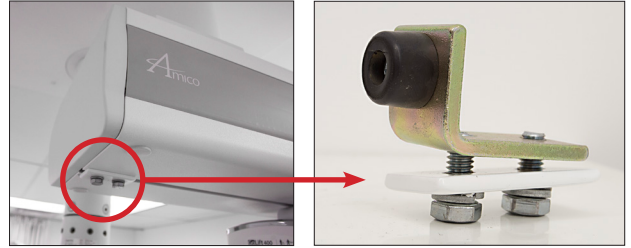

4. Fasten the endstops back on to the PLP track. Ensure there is enough clearance room to place the endcap on the PLP arm and place the endcap back on the arm.

5. Fasten all endstops tightly using an adjustable wrench.



NOTE: If you are installing the Amico GoLift Portable in an existing track system you must ensure that the max load of the track system is equal or higher than the max load of the Amico GoLift Portable.

6. To disconnect the lift from the trolley, open up the hook in the carabiner to release.

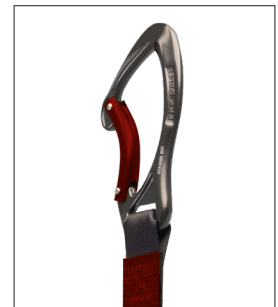

Installing the Endstop on the Amico Track



Use a 3/16 Allen key to secure the endstop to the track.



Amico Track Endstop

Using the Reacher Bar

1. With the lift resting on a bed, cart, table or other stationary object, use the down button on the lift or hand control to release enough of the strap to the point that will allow you to connect the carabiner to the trolley without having to pick up the lift from its position.
2. Open the carabiner latch by pressing the colored latch towards the back of the carabiner. This "opens" the carabiner so that it can be attached to the latch of the Reacher Arm. Once the carabiner is hooked onto the Reacher latch, release the latch of the carabiner so that it will be closed, and therefore locked in place.
3. Raise the Reacher Arm up to the trolley. Make sure there is enough slack on the lift strap to accomplish this step otherwise it will not be possible to hook on.
4. Slide the top hook of the Reacher Arm through the trolley. Make sure there is enough slack on the lift strap to accomplish this step otherwise it will not be possible to hook on.
5. The lift has now been securely hooked onto the trolley. The Reacher arm remains in position until the lift is removed.



Open carabiner to attach in slot of the Reacher bar.



Closed carabiner attached to latch of the Reacher bar.

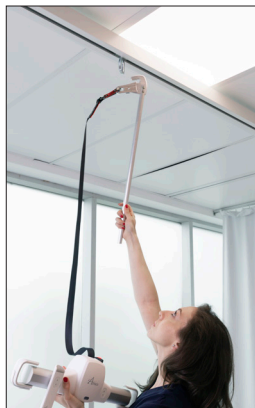

Raise the Reacher bar to the trolley.



Slide the top hook through the trolley.



Lift is securely hooked onto the trolley. The Reacher arm remains in position.

Magnetic Connection of the Hand Control to the GoLift Portable

Capacitive touch hand control – Allows users with limited dexterity to effortlessly operate the unit.

Magnetic Hand control connect for quick attachment to the GoLift Portable.



Do not place the hand control within 5" of a pacemaker. Patients with pacemakers must follow the instructions provided by their doctors.



Operating the GoLift Portable

The Amico GoLift Portable is switched on automatically when a button on the hand control is pressed. The Amico GoLift Portable switches off automatically after approximately three minutes without activation.

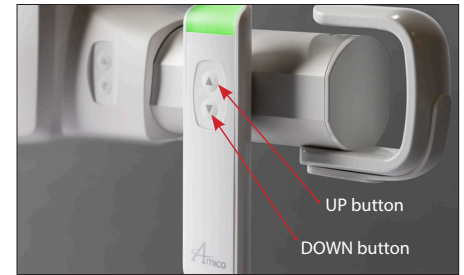

Charging the GoLift Portable

The charger plugs in into the port on the GoLift Portable.

The batteries should be charged on a regular basis. It is recommended that the lift be left on charge when not in operation, and at the end of each day. This will maximize the life cycle of the batteries.

The GoLift Portable may remain connected to the charger indefinitely since the charger has a built-in regulator, eliminating the danger of overcharging.

As a general rule, it is recommended that the lift be raised to a height that will not interfere with anything or anyone while the lift is not in use.



Do not drain the batteries excessively. This will dramatically reduce the lifespan of the batteries. If the slow beep sounds, be sure to recharge the battery as soon as possible.



If the GoLift Portable is not returned to the charger the batteries will be drained and damaged.

LED and Buzzer Functions

Charging	Battery	Main Lift LED	Main Lift Buzzer
Yes	Full	Green	N/A
No	Full	Green	N/A
Yes	Not full	Orange	N/A
No	Low	Flashing Orange	N/A
No	Very low	Solid Red	1 beep every 3 seconds
No	Max Current State	Flashing Red	Continuous beep until max current state excited
Yes	Charging	Solid Orange	N/A
Yes	Top-up	Solid Orange for 5 seconds when charger plugged in then solid Green	N/A
Yes	Battery over temp/ Sensor error	Flashing red	1 beep every 5 seconds
Yes	No temp sensor detected	Flashing red 3 times per second then 1 second off	1 beep every 5 seconds
	Function/Error	Main Lift LED	Main Lift Buzzer
	Ready to Repair	Flashing Green 4 times	N/A
	Emergency down	Solid Red	2 Beeps per second
Connection	Function/Error	Hand Control LED	Hand Control Buzzer
N/A	Unpair/Search	Flashing green then Red 3 times	N/A
N/A	Low battery	Solid Red	N/A
Connected	Show main lift LED status	Show main lift LED status	N/A
Maintenance Alarm			
At 1001 lifts, the LED will flash Green			
To reset, press Up button, then Down button, then Up button, then Down button and then hold both buttons for 10 seconds.			
If successful, the LED turns Red, Green and Orange. The buzzer beeps three times.			
Please note, that a reset can be performed at any time, not just after the 1000th lift.			

Emergency Stop

The GoLift Portable also has an Emergency Shut-off feature that allows the operator to shut-off the power to the lift completely in the event of an emergency. By pressing once on the RED emergency tab, located on the top of the lift, the lift will immediately stop and all its functions will be disabled. The ON indicator light will turn off, and the Emergency Shut-off button located inside the lift will pop out. After an emergency, the lift must be inspected prior to restoring to use. In order to restore power to the lift, the tab must be gently pulled.



Do not press the red tab forcefully. For assistance after an emergency, contact: Amico Service at: amo-service@amico.com or 1.877.462.64266



Emergency Lowering

In the event that the DOWN button on the hand control does not function, or in power failure situations, the patient may be lowered by pressing and holding down the RED emergency stop button located on the top of the lift. Continue to press down until the patient is safely lowered to the desired position. The lift will beep as you continue to press down on the red button and will continue beeping until the button is released after the desired lowering has been achieved.

NOTE: The emergency lowering button does not provide a raising function. The failure of any of the lowering devices should be reported to Amico Mobility.



In an event of emergency when normal lowering system of the lift malfunctions and the “emergency lowering” function is used, the lift must be reset by a qualified lift technician before re-use.

Emergency RED button

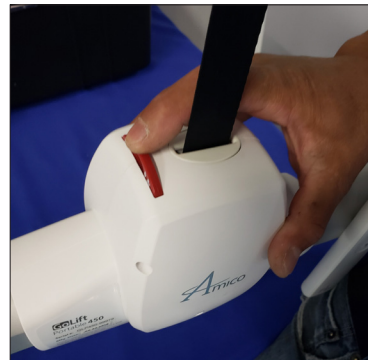

Continue to press down until the patient is safely lowered to the desired position.

Manual Emergency Lowering

The manual emergency and raising should only be used if the emergency lowering does not work. A proper safety ladder or stool may be required to remove the plug from the cover. Remove the round plug from the lift cover and use 3/16" or 2.5 mm Allen key to rotate the motor in the up or down direction.



Do not attempt to use the lift while using manual lowering.

Remove the round plug from the lift cover and use 3/16" or 2.5 mm Allen key to rotate the motor in the up or down direction.

Overspeed Cam

The Overspeed Cam brake is made of a metal bar fixed to the drum. In case of gear or motor breakage, the centrifugal force created will block the bar against the frame.

Cleaning and Disinfection

The exterior of the GoLift Portable should only be cleaned, disinfected using the recommended cleaning agents shown below. Damp a cloth with the cleaning agent and wipe down the entire exterior of the lift. Other chemicals and/or liquids not listed should not be used to clean and disinfect this lift.



Take great care to ensure that no liquids get inside the Amico GoLift Portable. The lift is not drip proof or water tight. Failure to protect the lift from liquids may result in damage to the lift and may cause personal injury.

Recommended cleaning agents:

- Virox Accel TB
- Virox 5
- Dispatch Hospital Cleaner disinfectant towels with Bleach
- Clorox Healthcare Professional Disinfecting Bleach Wipes
- Sani-Cloth super germicidal disposable wipes
- Viroidin-X

Clean the inside of the tracks every 4 months using a damp cloth to ensure a better trolleying surface for the trolley.

Troubleshooting

Should problems arise with the use of the Amico GoLift Portable, review the following chart. Find the fault and complete the recommended solution. If the fault is not found and or/the solution does not correct the problem contact Amico Mobility.

Fault	Recommended Solution
The GoLift Portable emits a slow beep while in use. The lift only goes down but not in the upwards direction.	The batteries are low and the lift should be charged.
The GoLift Portable cannot lift.	If the load is in excess of the safe working load the GoLift Portable will not work due to over-current protection.
The batteries are always dead after a few charges	Replace the batteries as they may be at the end of their service life
The GoLift Portable does not operate when you press the buttons on the hand control.	Check that the emergency cord is not pulled.
The lift does not go up	There may be a twist in the lift strap.

Inspection and Maintenance

Prior to using the Amico GoLift Portable, the inspections should be conducted per the following schedule:

Item	Before Use	Every Month	Annual
GoLift Portable	•		
Ensure that endstops are installed	•		
Inspect strap for wear or fraying	•		
Ensure Batteries are charged	•		
Inspect hooks for damage or sharp edges			•
Inspect the wheels in the portable trolley. Replace if damaged.			•
Sling			
Check all straps for wear or fraying	•		
Inspect the sling for any damage in the fabric		•	
Ensure there are no loose threads in the stitching	•		
Maintenance by a certified technician			
Check the strap and replace only if frayed or damaged			•
Inspect the gearbox for any unusual noises			•
Inspect the hook components for any signs of damage			•
Inspect the gears for any broken or worn teeth			•
** Verify the overspeed cam is operating freely			•
Check emergency stop tab			•
** Check emergency lowering device			•
*Annual load test with SWL (maximum safe working load)			•
Ensure the endstops are installed			•

* In accordance to the ISO 10535 Standard “Hoists for the transfer of disabled persons – Requirements and test methods” an inspection should be performed on the GoLift Portable at least once a year. This inspection should be performed by a qualified technician and should include a working load test of one (1) lifting cycle with the maximum load.

** These two functions must be checked by a qualified technical to ensure the essential performance of the GoLift Portable.



Do not operate the GoLift Portable until any issues discovered during the inspection have been addressed by a certified technician.

GoLift Portable Accessories

	Slings	Material	S	M	L	XL
GoBasic	GoBasic With Head Support	Polyester	SLG-GO-BASIC-WV-HS-S	SLG-GO-BASIC-WV-HS-M	SLG-GO-BASIC-WV-HS-L	SLG-GO-BASIC-WV-HS-XL
	GoBasic With Head Support	Mesh	SLG-GO-BASIC-MSH-HS-S	SLG-GO-BASIC-MSH-HS-M	SLG-GO-BASIC-MSH-HS-L	SLG-GO-BASIC-MSH-HS-XL
	GoBasic No Head Support	Polyester	SLG-GO-BASIC-WV-S	SLG-GO-BASIC-WV-M	SLG-GO-BASIC-WV-L	SLG-GO-BASIC-WV-XL
	GoBasic No Head Support	Mesh	SLG-GO-BASIC-MSH-S	SLG-GO-BASIC-MSH-M	SLG-GO-BASIC-MSH-L	SLG-GO-BASIC-MSH-XL
GoLong	GoLong	Polyester	SLG-GO-LONG-WV-42X78		SLG-GO-LONG-WV-56X78	
	GoLong	Mesh	SLG-GO-LONG-MSH-42X78		SLG-GO-LONG-MSH-56X78	
GoHygiene	GoHygiene	Polyester	SLG-GO-HYGIENE-WV-S	SLG-GO-HYGIENE-WV-M	SLG-GO-HYGIENE-WV-L	SLG-GO-HYGIENE-WV-XL
GoComfort	GoComfort	Polyester	SLG-GO-COMFORT-WV-S	SLG-GO-COMFORT-WV-M	SLG-GO-COMFORT-WV-L	SLG-GO-COMFORT-WV-XL

Guidelines For Choosing Your Sling Size

	S	M	L	XL
Height	31.4 - 34.5" / 798 - 876 mm	33.4 - 36.2" / 848 - 820 mm	35.4 - 38.2" / 899 - 970 mm	37.4 - 41.3" / 950 - 1049 mm
Width	14.2 - 15.8" / 361 - 401 mm	15.4 - 17" / 391 - 432 mm	16.5 - 17.7" / 419 - 450 mm	19 - 20.5" / 483 - 521 mm

Washing Instructions



Normal washing at indicated temperature



Do not bleach



Tumble dry low



Do not iron



Do not dry clean

GoTrack Systems and Support Structure

GoTrack Configurations

We offer three different track profiles, as well as modular and custom configurations that come in:

- Straight Track
- Curved Systems
- Full Room Coverage (X/Y or H Systems)
- Optional Infection Control Track
- Optional recessed, flush mount track systems

All GoTrack Systems feature:

- Low weight and high capacity
- Fast and flexible installation
- Hidden Endstops for safety
- Anywhere charge

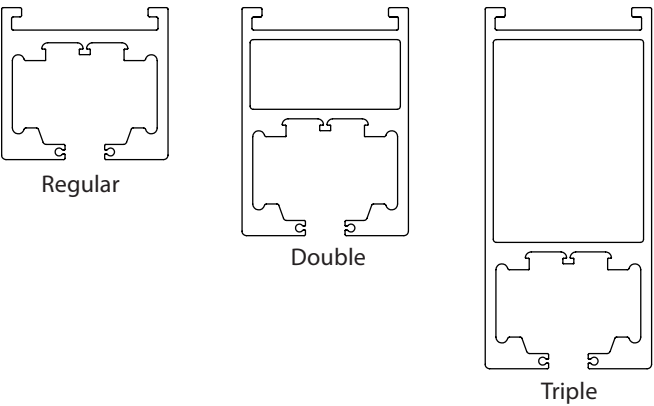

Description	Part Number	Length x Width x Height	Product Weight	Material
Regular	TRK-REG-96	96 x 2.63 x 2.36" / 2440 x 67 x 60 mm	8.3 lbs / 3.77 kg	White powder coated extruded aluminum
Regular	TRK-REG-120	120 x 2.63 x 2.36" / 3050 x 67 x 60 mm	8.3 lbs / 3.77 kg	White powder coated extruded aluminum
Regular	TRK-REG-240	240 x 2.63 x 2.36" / 6100 x 67 x 60 mm	8.3 lbs / 3.77 kg	White powder coated extruded aluminum
Double	TRK-DBL-120	120 x 2.63 x 3.55" / 3050 x 67 x 90 mm	10.4 lbs / 4.72 kg	White powder coated extruded aluminum
Double	TRK-DBL-150	150 x 2.63 x 3.55" / 3800 x 67 x 90 mm	10.4 lbs / 4.72 kg	White powder coated extruded aluminum
Double	TRK-DBL-240	240 x 2.63 x 3.55" / 6100 x 67 x 90 mm	10.4 lbs / 4.72 kg	White powder coated extruded aluminum
Triple	TRK-TRP-120	120 x 2.63 x 5.75" / 3050 x 67 x 146 mm	12.4 lbs / 5.65 kg	White powder coated extruded aluminum
Triple	TRK-TRP-240	240 x 2.63 x 5.75" / 6100 x 67 x 146 mm	12.4 lbs / 5.65 kg	White powder coated extruded aluminum
Custom	Custom lengths in any track type available upon request			

Environmental Conditions

Operation		
	Minimum	Maximum
Temperature	+10°C	+40°C
Relative atmospheric humidity	30%	75%
Air pressure	700 hPa	1060 hPa

Transport/Storage		
	Minimum	Maximum
Temperature	-10°C	+50°C
Relative atmospheric humidity	20%	90%
Air pressure	700 hPa	1060 hPa

NOTE: It is recommended that the lift be brought back to an area kept at room temperature between uses. For example after transport in a vehicle do not leave the lift in the trunk or backseat.

Also, try to keep the lift from staying in rooms with a metallic roof where temperatures may increase the allowable operating temperature.

References on the Package

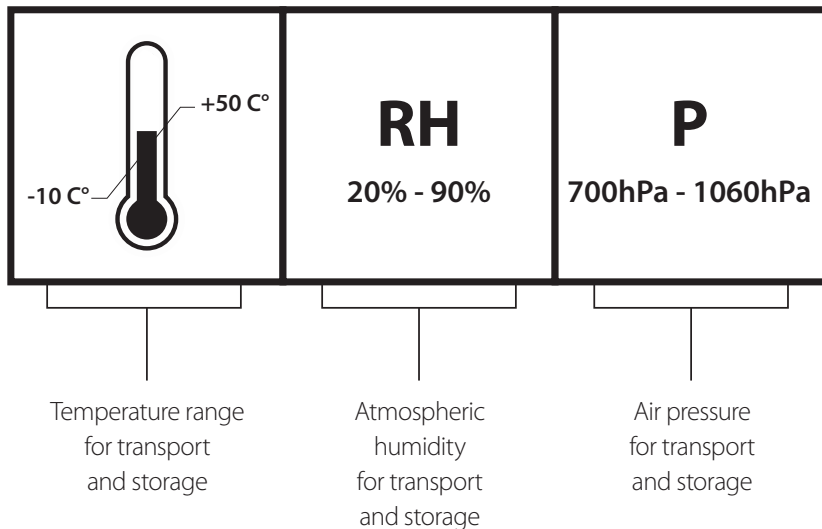

Electro-Magnetic Compliance Data for Amico GoLift Portable

Guidance and Manufacturer's Declaration - Electromagnetic Emissions		
The [EQUIPMENT or SYSTEM] is intended for use in the electromagnetic environment specified below. The customer or the user of the [EQUIPMENT or SYSTEM] should assure that it is used in such an environment.		
Emissions Test	Compliance	Electromagnetic environment – guidance
RF emissions CISPR 11	Group 1	The [EQUIPMENT or SYSTEM] uses RF energy only for its internal function. Therefore, its RF emissions are very low and are not likely to cause any interference in nearby electronic equipment.
RF emissions CISPR 11	Class A	The [EQUIPMENT or SYSTEM] is suitable for use in all establishments other than domestic establishments and those directly connected to the public low-voltage power supply network that supplies buildings used for domestic purposes.
Harmonic emissions IEC 61000-3-2	Class A	
Voltage fluctuations / flicker emissions IEC 61000-3-3	Complies	

Use of this equipment adjacent to or stacked with other equipment should be avoided because it could result in improper operation. If such use is necessary, this equipment and the other equipment should be observed to verify that they are operating normally.

Use of accessories and cables other than those specified by Amico Mobility, could result in increased electromagnetic emissions or decreased electromagnetic immunity of this equipment, and result in improper operation.

Portable RF communications equipment should be no closer than 30 cm to any part of the Amico GoLift Portable 450. Otherwise, degradation of the performance of this equipment could result.

Electro-Magnetic Compliance Data For Amico GoLift Portable

Guidance and Manufacturer's Declaration - Electromagnetic Emissions			
The [EQUIPMENT or SYSTEM] is intended for use in the electromagnetic environment specified below. The customer or the user of the [EQUIPMENT or SYSTEM] should assure that it is used in such an environment.			
Immunity Test	IEC 60601 Test Level	Compliance Level	Electromagnetic Environment – Guidance
Electrostatic discharge (ESD) IEC 61000-4-2	±6 kV contact ±8 kV air	±6 kV contact ±8 kV air	Floors should be wood, concrete or ceramic tile. If floors are covered with synthetic material, the relative humidity should be at least 30 %
Electrical fast transient/burst IEC 61000-4-4	±2 kV for power supply lines ±1 kV for input/output lines	±1 kV for power supply lines ±0.250 kV for input/output lines	Mains power quality should be that of a typical commercial or hospital environment.
Surge IEC 61000-4-5	±1 kV line(s) to line(s) ±2 kV line(s) to earth	±1 kV line(s) to line(s) ±2 kV line(s) to earth	Mains power quality should be that of a typical commercial or hospital environment.
Voltage dips, short interruptions and voltage variations on power supply input lines IEC 61000-4-11	<5 % UT (>95 % dip in UT) for 0,5 cycle 40 % UT (60 % dip in UT) for 5 cycles 70 % UT (30 % dip in UT) for 25 cycles <5 % UT (>95 % dip in UT) for 5 sec	<5 % UT (>95 % dip in UT) for 0,5 cycle 40 % UT (60 % dip in UT) for 5 cycles 70 % UT (30 % dip in UT) for 25 cycles <5 % UT (>95 % dip in UT) for 5 sec	Mains power quality should be that of a typical commercial or hospital environment. If the user of the [EQUIPMENT or SYSTEM] requires continued operation during power mains interruptions, it is recommended that the [EQUIPMENT or SYSTEM] be powered from an interruptible power supply or a battery.
Power frequency (50/60 Hz) magnetic field IEC 61000-4-8	3 A / m	Not Applicable	Power frequency magnetic fields should be at levels characteristic of a typical location in a typical commercial or hospital environment.
NOTE: U_T is the a.c. mains voltage prior to application of the test level.			

Electro-Magnetic Compliance Data For Amico GoLift Portable

Guidance and Manufacturer's Declaration - Electromagnetic Emissions			
<p>The [EQUIPMENT or SYSTEM] is intended for use in the electromagnetic environment specified below.</p> <p>The customer or the user of the [EQUIPMENT or SYSTEM] should assure that it is used in such an environment.</p>			
Emissions test	IEC 60601 Test Level	Compliance Level	Electromagnetic Environment – Guidance
$\sqrt{\text{Conducted RF}}$ IEC 61000-4-6	3 Vrms 150 kHz to 80 MHz	3 Vrms	<p>Portable and mobile RF communications equipment should be used no closer to any part of the [ME EQUIPMENT or ME SYSTEM], including cables, than the recommended separation distance calculated from the equation applicable to the frequency of the transmitter.</p> <p>Recommended separation distance</p> $d = 1.2 \sqrt{P}$ $d = 1.2 \sqrt{P} \text{ 80 MHz to 800 MHz}$ $d = 2.3 \sqrt{P} \text{ 800 MHz to 2,5 GHz}$
Radiated RF IEC 61000-4-3	3 V/m 80 MHz to 2,5 GHz	3 V/m	<p>where P is the maximum output power rating of the transmitter in watts (W) according to the transmitter manufacturer and d is the recommended separation distance in meters (m). Field strengths from fixed RF transmitters, as determined by an electromagnetic site survey, ^a should be less than the compliance level in each frequency range. ^b</p> <p>Interference may occur in the vicinity of equipment marked with the following symbol:</p> 
<p>NOTE 1: At 80 MHz and 800 MHz, the higher frequency range applies.</p> <p>NOTE 2: These guidelines may not apply in all situations. Electromagnetic propagation is affected by absorption and reflection from structures, objects and people.</p>			
<p>^a. Field strengths from fixed transmitters, such as base stations for radio (cellular/cordless) telephones and land mobile radios, amateur radio, AM and FM radio broadcast and TV broadcast cannot be predicted theoretically with accuracy. To assess the electromagnetic environment due to fixed RF transmitters, an electromagnetic site survey should be considered. If the measured field strength in the location in which the [ME EQUIPMENT or ME SYSTEM] is used exceeds the applicable RF compliance level above, the [ME EQUIPMENT or ME SYSTEM] should be observed to verify normal operation. If abnormal performance is observed, additional measures may be necessary, such as re-orienting or relocating the [ME EQUIPMENT or ME SYSTEM].</p> <p>^b. Over the frequency range 150 kHz to 80 MHz, field strengths should be less than 3 V/m.</p>			

Electro-Magnetic Compliance Data For Amico GoLift Portable

Recommended separation distances between portable and mobile RF communications equipment and the [EQUIPMENT or SYSTEM]			
The [EQUIPMENT or SYSTEM] is intended for use in an electromagnetic environment in which radiated RF disturbances are control LED. The customer or the user of the [EQUIPMENT or SYSTEM] can help prevent electromagnetic interference by maintaining a minimum distance between portable and mobile RF communications equipment (transmitters) and the [EQUIPMENT or SYSTEM] as recommended below, according to the maximum output power of the communications equipment.			
Rated maximum output power of transmitter W	Separation distance according to frequency of transmitter M		
	150 kHz to 80 MHz $d = 1.2\sqrt{P}$	150 kHz to 80 MHz $d = 1.2\sqrt{P}$	800 MHz to 2,5 GHz $d = 1.2\sqrt{P}$
0,01	0.12	0.12	0.23
0,1	0.38	0.38	0.73
1	1.2	1.2	2.3
10	3.8	3.8	7.3
100	12	12	23
For transmitters rated at a maximum output power not listed above, the recommended separation distance d in meters (m) can be estimated using the equation applicable to the frequency of the transmitter, where P is the maximum output power rating of the transmitter in watts (W) according to the transmitter manufacturer.			
NOTE 1: At 80 MHz and 800 MHz, the separation distance for the higher frequency range applies.			
NOTE 2: These guidelines may not apply in all situations. Electromagnetic propagation is affected by absorption and reflection from structures, objects and people.			

Disposal

- The Amico GoLift Portable doesn't contain any dangerous goods.
- The components of the Amico GoLift Portable should be properly disposed at the end of its shelf-life.
- Make sure that the materials are carefully separated.
- The electrical conducting boards should be submitted to an appropriate recycling proceeding.
- The rest of the components should be disposed according to the contained materials.



Warranty Policy - Mobility Solutions

The primary purpose of our ceiling lift system is to safely lift, transfer and reposition a patient with as little effort as possible for the caregiver, regardless of the room type. The Amico Mobility Solutions Corporation's GoLift is easy and safe to use for caregivers as well as patients. The lift systems fit into all environments and fulfill the highest requirements of function, safety and reliability.

Amico Mobility Solutions Corporation warrants its lifting equipment and workmanship to be free from defects for a period of three (3) years from the date of installation. This includes tracks, lift motor, carry bar and accessories. The Amico slings have a warranty of two (2) years.

Within this period, Amico Mobility Solutions Corporation will replace any part (at no additional charge), which is deemed defective. Shipping and installation costs after the first twelve (12) months will be borne by the customer. The following exclusions apply: the warranty for batteries is for a period of three (3) months from the time of installation; the warranty for power supply is one (1) year from the time of installation.

This warranty is valid only when the product has been properly installed as outlined in the Amico Mobility Solutions Corporation specifications; including but not limited to proper usage and servicing of systems according to factory recommendations. It does not cover damages as a result of shipment failures, accidents, misuse, abuse, neglect, mishandling, alternation, misapplication or damages which may be attributed to acts of God.

Amico Mobility Solutions Corporation shall not be liable for incidental or consequential damages resulting from the use of the equipment.

All claims for warranty must first be approved by Amico Mobility Solutions Corporation's Service Department at amo-service@amico.com or 1.877.462.6426. A valid Return Goods Authorization (RGA) number must be obtained from Amico Mobility Solutions Corporation prior to commencement of any service work. Warranty work which has not been per-authorized by Amico Mobility will not be reimbursed.



Notes

Notes

Notes

www.amico.com

Amico Mobility Solutions Corporation | 122-B East Beaver Creek Road, Richmond Hill, ON L4B 1G6, Canada
600 Prime Place, Hauppauge, NY 11788, USA
Toll Free Phone: 1.877.462.6426 | Toll Free Fax: 1.866.440.4986 | Tel: 905.764.0800 | Fax: 905.764.0862
Email: amo-service@amico.com | www.amico.com



AJW Technology Consulting GmbH
Königsallee 106
40215 Düsseldorf
Germany