

ApexRemote

AIRBORNE PARTICLE COUNTERS



Apex represents everything that is important in a world class Environmental Monitoring System. It is the Best In Class sensor and meets all the industry standards. The Risk Mitigation features of Self-Diagnostics and SmartBracket virtually eliminate data errors.

Apex provides real time continuous data collection at a cost effective price per point offering unmatched performance, accuracy and reliability.

Apex provides all this in an enclosure that is compatible with industry standard decontamination processes.

FEATURES

- 0.2 – 10.0 μm Particle Size Range.
- 1.0 CFM or 0.1 CFM Flow Rates.
- 3,000 Records Data Storage.
- Self-Diagnostics.
- Web Browser.
- Smart Bracket.
- Validation Mode.
- Built in Alarm Light.
- 2 year warranty.

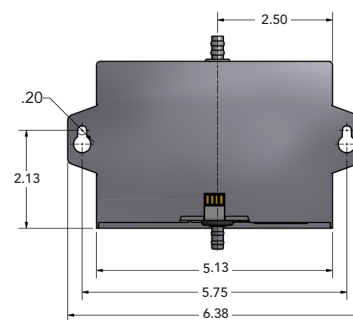
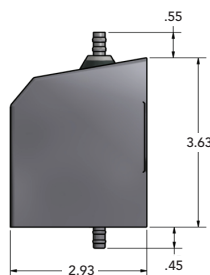
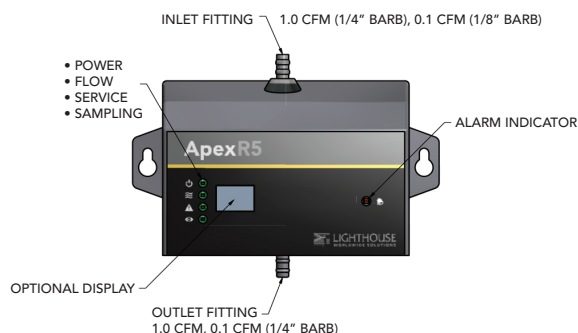

TECHNICAL DATASHEET

Apex Remote Airborne Particle Counters

| Features / Models | ApexR3 | ApexR5 | ApexR02 | ApexR03 | ApexR05 |
|------------------------------|---|---------------------------------------|---|---------------------------------|---------------------------------------|
| Minimum Size Detection | 0.3 μm | 0.5 μm | 0.2 μm | 0.3 μm | 0.5 μm |
| Standard 2 channel sizes | 0.3, 0.5 μm | 0.5, 5.0 μm | 0.2, 0.3 μm | 0.3, 0.5 μm | 0.5, 5.0 μm |
| Optional 4 channel sizes | 0.3, 0.5, 1.0, 5.0 μm | 0.5, 1.0, 5.0, 10.0 μm | 0.2, 0.3, 0.5, 1.0 μm | 0.3, 0.5, 1.0, 5.0 μm | 0.5, 1.0, 5.0, 10.0 μm |
| Additional Available sizes | 0.3, 0.5, 0.7, 1.0, 3.0, 5.0 μm | 0.5, 0.7, 1.0, 3.0, 5.0, 7.0, 10.0 μm | 0.2, 0.3, 0.5, 0.7, 1.0, 2.0 μm | 0.3, 0.5, 0.7, 1.0, 3.0, 5.0 μm | 0.5, 0.7, 1.0, 3.0, 5.0, 7.0, 10.0 μm |
| Flow Rate / Nozzel Size | 1 CFM (28.3 LPM), 1/4" inlet and outlet fitting | | 0.1 CFM (2.83 LPM), 1/8" inlet, 1/4" outlet fitting | | |
| Weight | 1.6 lbs (0.73 kg) | | 1.4 lbs (0.63 kg) | | |
| Communication | Ethernet or Serial. | | | | |
| Modbus Protocols | TCP or RTU or ASCII | | | | |
| Data Storage Records | 3,000 | | | | |
| Self Diagnostics | Laser power supply, laser current, laser power, photo detector power supply, background voltage, photo detector health. | | | | |
| Web Server | Remote access via web browser | | | | |
| Validation Mode | Yes | | | | |
| Alarm Light | Yes | | | | |
| Enclosure | 304 Stainless Steel | | | | |
| Power | 24 VDC, PoE | | | | |
| External Vacuum Requirements | Nominal 1.0 CFM 18" (45.72 cm) of Hg | | | | |
| Light Source | Laser Diode | | | | |
| Calibration | Designed for ISO 21501-4 Compliance | | | | |
| Zero Count Level | <1 count/5 minutes per ISO 21501-4 | | | | |
| Concentration Limits 1.0 CFM | 1,000,000 particles/ft³@10% (34,300,000/m³) coincidence loss suitable for ISO classes 1-8 cleanrooms | | | | |
| Concentration Limits 0.1 CFM | 4,000,000 particles/ft³@10% (137,200,000/m³) coincidence loss suitable for ISO classes 1-8 cleanrooms | | | | |
| Counting Efficiency | 50% @ minimum channel size, 100% for particles >1.5 X - 2X channel particle size | | | | |
| Dimensions | 6.38"x 2.93"x 4.63" (16.2x7.4x11.7 cm) | | | | |

Options Available for all Models

Software LMS Express or LMS Express RT or LMS Pharma

OLED Display

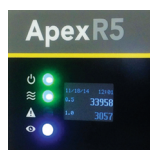

Smart Bracket Wall Mount Flush

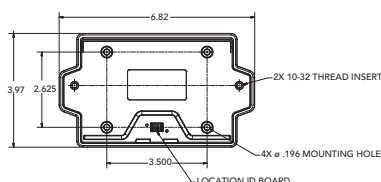

Smart Bracket Wall Mount Through Base

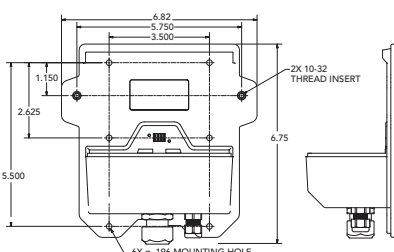

Smart Bracket Wall Mount Through Wall

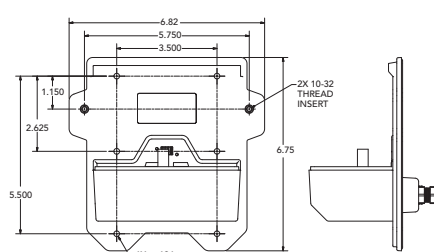

Distributed By:



Lighthouse Worldwide Solutions reserves the right to change specifications without notice.

www.golighthouse.com 1-800 945 5905 (Tollfree)
info@golighthouse.com 1-541 770 5905 (Outside of USA)

